



BLATCH
FINE HOMES

Tel: +44 (0) 24 7624 9333

info@blatchfinehomes.co.uk



45 Lime Tree Avenue

Bilton, Rugby, CV22 7QT

Offers over £1,100,000



6



3



3



C

45 Lime Tree Avenue



Description

Nestled within the coveted Lime Tree Avenue, this property boasts an expansive plot and offers flexible family living spaces. The home features a sizable kitchen/breakfast room overlooking the lush rear garden, alongside three reception rooms and 6 bedrooms.

- Beautiful Family Home In Bilton
- Picturesque and Well-Maintained Gardens
- 6 Bedrooms and 4 Bathrooms, including one en-suite
- Garage and Garden Room
- EPC Rating - C
- Generous Plot
- Sought After Location
- Spacious Accommodation
- Three Reception Rooms
- Council Tax Band G





Floor Plan

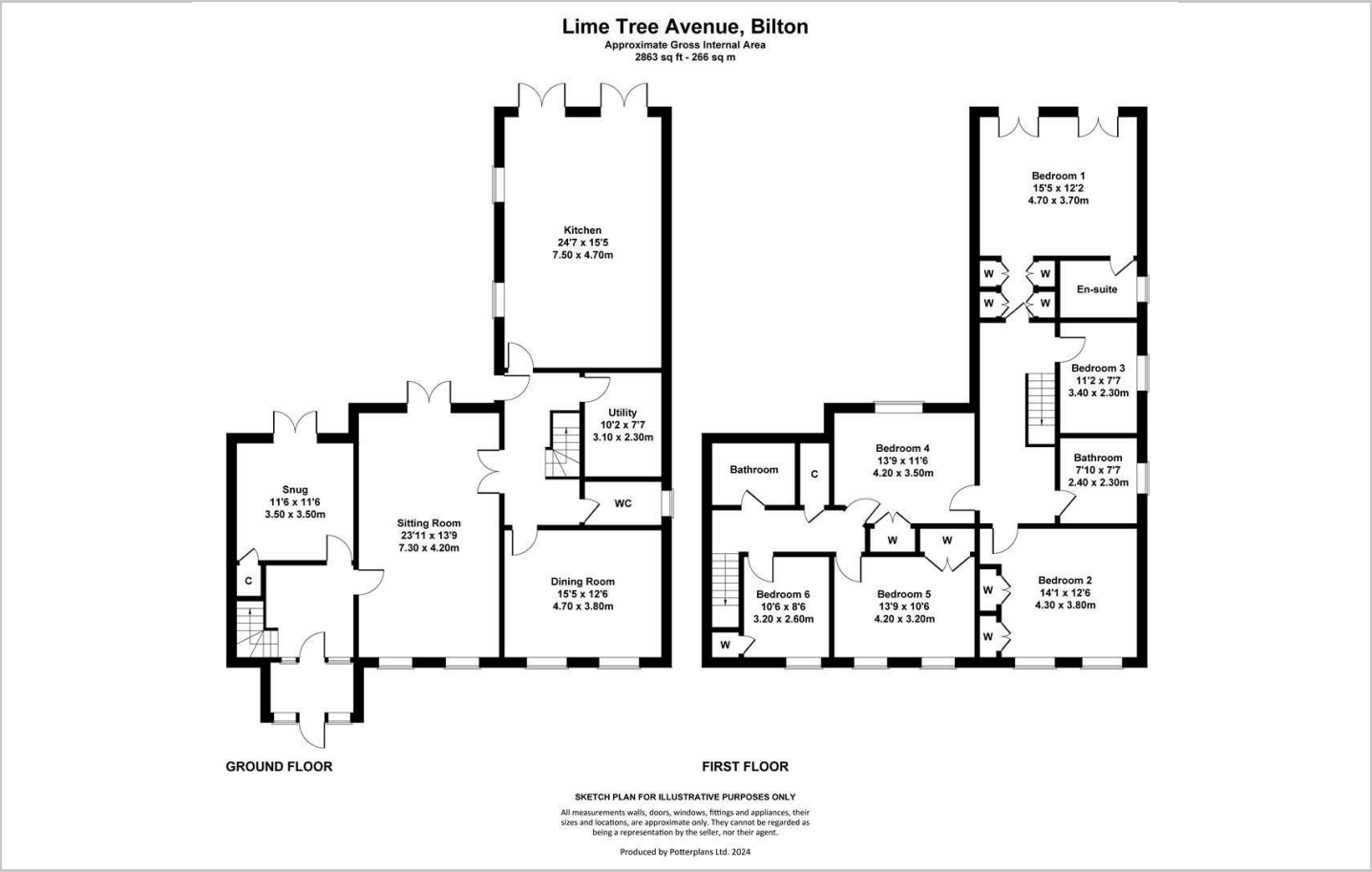

Area Map



Viewing

Please contact our Coventry Office on 02476249333 if you wish to arrange a viewing appointment for this property or require further information.

These particulars, whilst believed to be accurate are set out as a general outline only for guidance and do not constitute any part of an offer or contract. Intending purchasers should not rely on them as statements of representation of fact, but must satisfy themselves by inspection or otherwise as to their accuracy. No person in this firms employment has the authority to make or give any representation or warranty in respect of the property.

Energy Efficiency Graph

